

INSTALLATION MANUAL

11686

Level of Difficulty

Moderate

Installation difficulty levels are based on time and effort involved and may vary depending on the installer level of expertise, condition of the vehicle and proper tools and equipment.

Weight Carrying Capacity

Gross trailer weight (GTW)	2,000 lbs.
Tongue weight (TW)	200 lbs.

Parts List

Item	Qty	Description
1	1	Trailer hitch
2	1	U-bolt, 3/8"-16 x 1.938" x .875"
3	4	Hex bolt, M10-1.25 x 40mm, CL 10.9
4	2	Serrated-flange nut, 3/8"-16
5	4	Conical-toothed washer, 7/16"

Tools Required

Ratchet	Torque wrench
Socket, 10mm	Socket extension, 3"
Socket, 13mm	Flathead screwdriver
Socket, 14mm	Tape measure
Socket, 17mm	Rotary tool

* For a tools reference guide visit curtmfg.com/trailer-hitch-installation

Product Registration and Warranty

CURT stands behind our products with industry-leading warranties. To get copies of the product warranties, register your purchase or provide feedback, visit: warranty.curtgroup.com/surveys

⚠ WARNING

Never exceed the vehicle manufacturer's recommended towing capacity.

Product Photo



NOTICE

Visit www.curtmfg.com for a full-color copy of this instruction manual, as well as helpful videos, guides and much more!

Before you begin installation, read all instructions thoroughly.

Proper tools will improve the quality of installation and reduce the time required.

This installation requires:

- Trimming of the underbody panel

Periodic inspection of the trailer hitch should be performed to ensure all mounting hardware remains tight and structural components are secure.

To help prevent damage to the product or vehicle, refer to the specified torque specifications when securing hardware during the installation process.

SAFETY INSTRUCTIONS

Safety glasses should be worn at all times while installing this product.

ASSEMBLY

Parts List

Item	Qty	Description
1	1	Trailer hitch
2	1	U-bolt, 3/8"-16 x 1.938" x .875"
3	4	Hex bolt, M10-1.25 x 40mm, CL 10.9
4	2	Serrated-flange nut, 3/8"-16
5	4	Conical-toothed washer, 7/16"

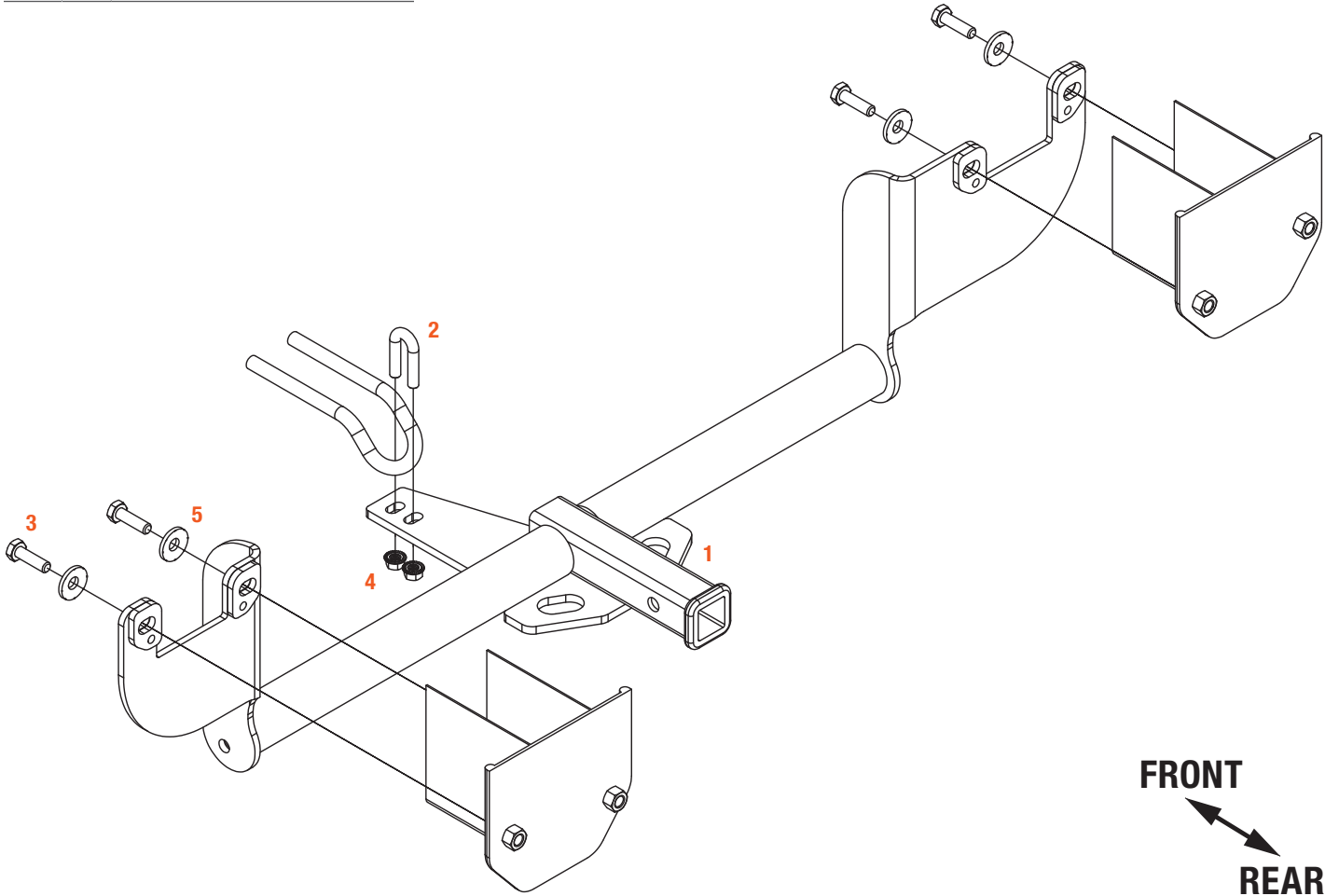

CONICAL TOOTHED WASHER ORIENTATION

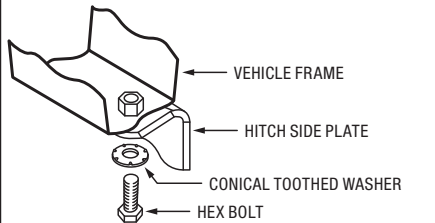

Step 1

Using a flathead screwdriver, remove three (3) push fasteners from the underbody panel. Using a 10mm socket, remove the nut near the trunk pan and then using a 13mm socket, remove the nut near the frame rail. Carefully remove the underbody panel and lay it aside for trimming and reinstallation in step 6.



Step 2

Using a 14mm socket, remove the two (2) bolts holding the bumper beam to the trunk pan.

Note: Lowering the exhaust may ease installation. To lower the exhaust, remove its two (2) rubber isolators and place jack stands or other supports under the exhaust to prevent damage to the vehicle.



Step 3

Place the 3/8" U-bolt (#2) over the vehicle recovery loop.



Step 4

Raise the hitch (#1) into position and slide the U-bolt (#2) through the holes on the hitch, then loosely secure the hitch in place with the supplied M10 bolts (#3) and 7/16" conical-toothed washers (#5). Then secure the U-bolt with the 3/8" serrated-flange nuts (#4).



Step 5

Torque hardware to the following specifications:

Torque M10 hardware to 48 ft-lb.

Torque 3/8" hardware to 26 ft-lb.



Step 6

Trim the underbody panel using the provided trim diagram as a reference and reinstall it using the original hardware set aside in step 1.



TOWING BASICS & SAFETY INFORMATION

For information on safely towing your trailer, visit curtmfg.com/understanding-towing.